

Thank you for purchasing the Yamaha DTX482K! As a high-end model of the DTX402 series, the DTX482K comes standard with three cymbal pads (two crashes and one ride) and the DTX-series XP80 Snare Pad. We recommend that you read this manual carefully so that you can fully take advantage of the advanced and convenient functions of the instrument. We also recommend that you keep this manual in a safe and handy place for future reference.

Before using this product, be sure to read the "PRECAUTIONS" on pages 4 to 5 on the DTX402K, DTX432K, and DTX452K Owner's Manual.

**NOTICE**

Some objects made of rubber and similar materials can easily stain the drumhead of the snare pad. Do not leave such objects in contact with the drumhead for a long period of time. Pay special attention to avoid stacking the pads when putting them in storage, for example.

# 1. Package Content

After opening up the package containing your electronic drum kit, please verify that all of the following parts are present.

**DTX482K Package Content**

- Rack (Large)
- Rack (Small)
- Rod for the snare pad
- Hi-hat holder
- Cymbal holders (x2)
- Drum module
- Cymbal/hi-hat pads (x2)
- Crash cymbal pad
- HH65 Hi-hat controller
- Nine-channel snake cable
- Drum key
- Cable bands (x3)
- AC adaptor
- DTX482K Owner's Manual (this booklet)
- DTX402K, DTX432K, and DTX452K Owner's Manual
- KP65 Owner's Manual
- XP70, XP80 Owner's Manual

**Additional Cymbal pad**

- Cymbal pad (x1)
- Cymbal holder (x1)
- Stopper (x1)
- XP80 main unit (x1)
- Clamp bolt (x1)
- Stereo audio cable (x1)

**XP80 Snare Pad**

- XP80 main unit (x1)
- Clamp bolt (x1)

# 2. Assembly Guide (1/2)

To assemble the DTX482K, refer to this Owner's Manual and the DTX402K, DTX432K, and DTX452K Owner's Manual

**Fully Assembled DTX482K**

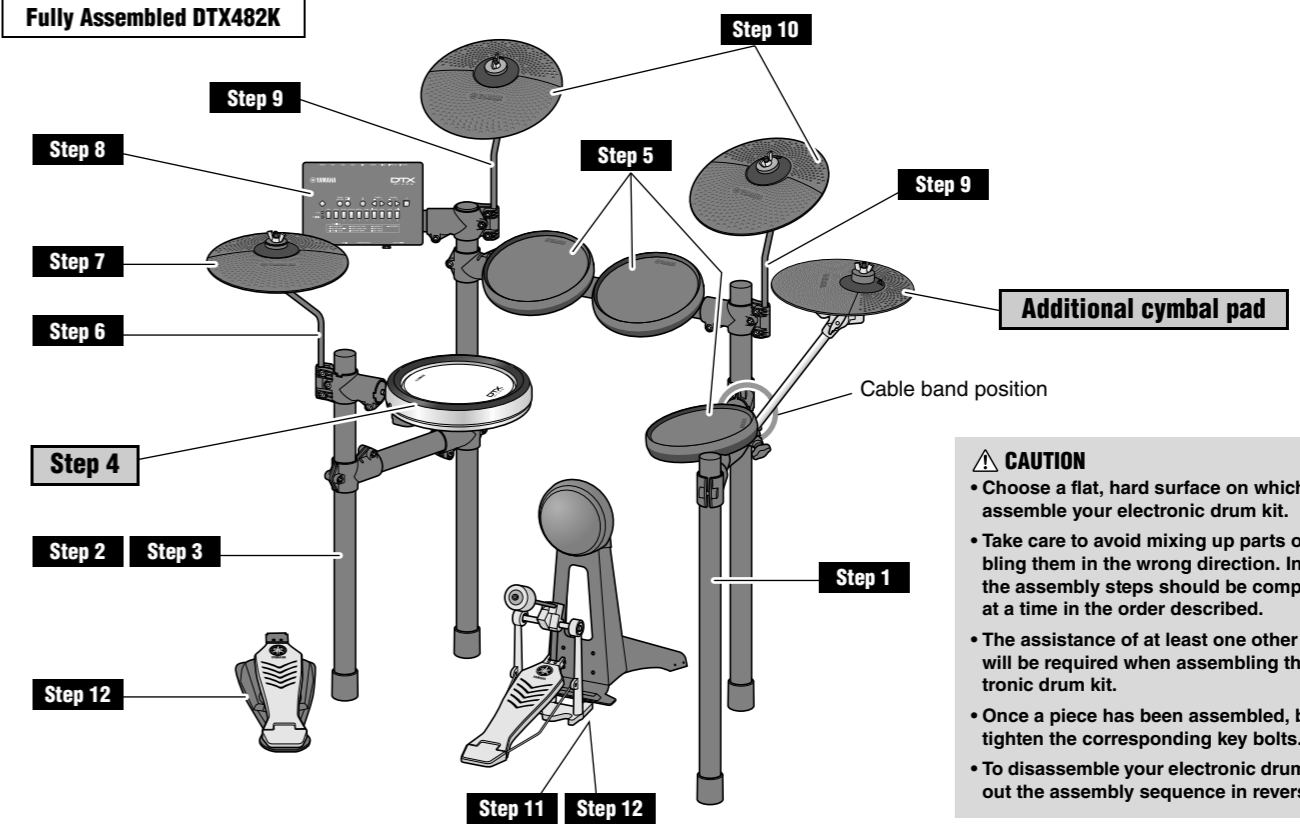

**CAUTION**

- Choose a flat, hard surface on which to assemble your electronic drum kit.
- Take care to avoid mixing up parts or assembling them in the wrong direction. In addition, the assembly steps should be completed one at a time in the order described.
- The assistance of at least one other person will be required when assembling the electronic drum kit.
- Once a piece has been assembled, be sure to tighten the corresponding key bolts.
- To disassemble your electronic drum kit, carry out the assembly sequence in reverse.

**Attaching the cymbal holder for the additional cymbal pad.**

1. Loosen the (■1, ■2) key bolts and detach the pipe for TOM3.

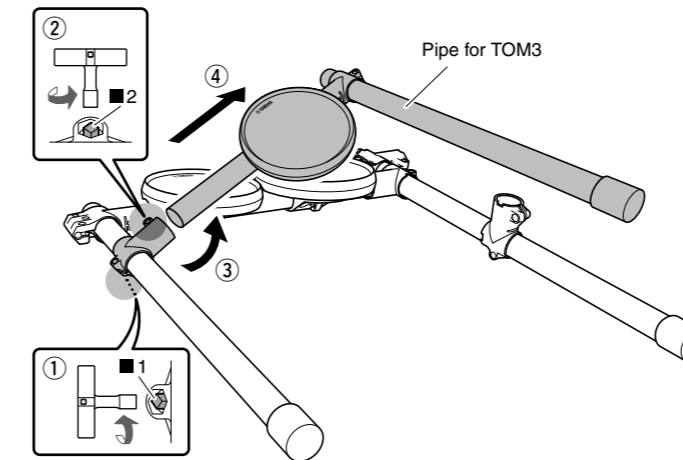

2. Loosen the clamp bolt of the cymbal holder.

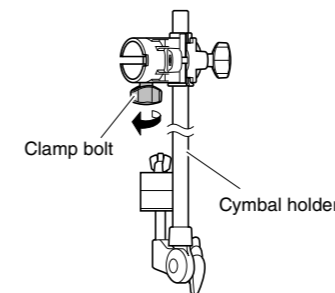

3. Slide the holder clamp onto the TOM3 pipe, and lightly tighten the clamp bolt of the cymbal holder.

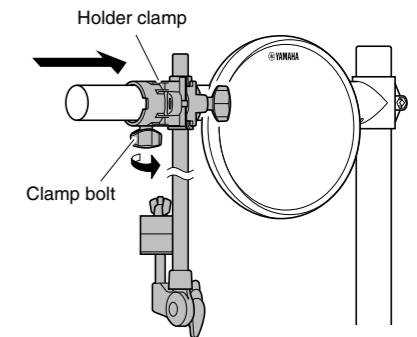

4. Attach the TOM3 pipe back to the large rack.

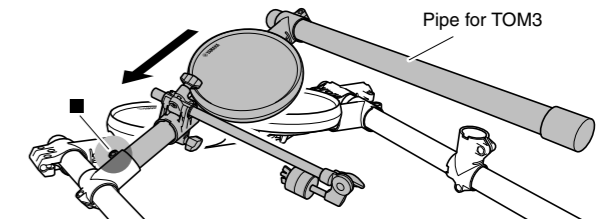

5. Tighten the key bolt (■ in the above figure) on the large rack and the clamp bolt of the cymbal holder.

**Step 1** } Turn the entire large rack over and continue with the assembly by following the instructions on pages 13 and 14 of the DTX402K, DTX432K, and DTX452K Owner's Manual

**Step 2** }

**Step 3** }

Continue to the other side. →

## 2. Assembly Guide (2/2)

### Step 4 Attaching the XP80 Snare Pad

1. Attach the rod for the snare pad to the small rack, and then tighten the key bolt (★) by using a tuning key to secure the rod.

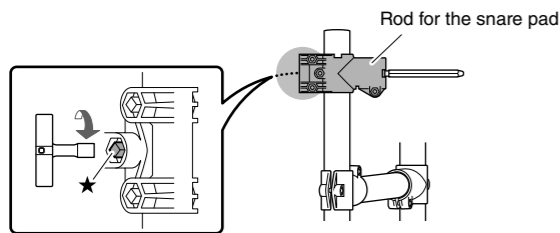

2. Lightly screw the clamp bolt into the socket on the snare pad. (Rotate the clamp bolt five to six times.)

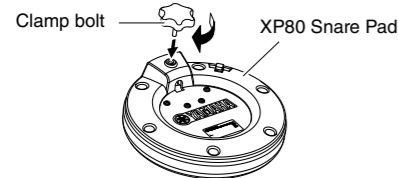

3. Attach the XP80 Snare Pad to the rod, and then tighten the clamp bolt to secure the snare pad.

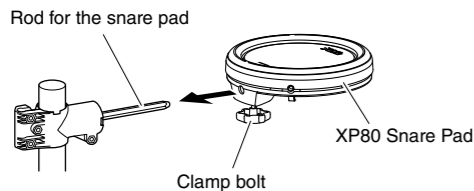

#### CAUTION

Leave a gap of about a half inch between the base of the rod and the snare pad.

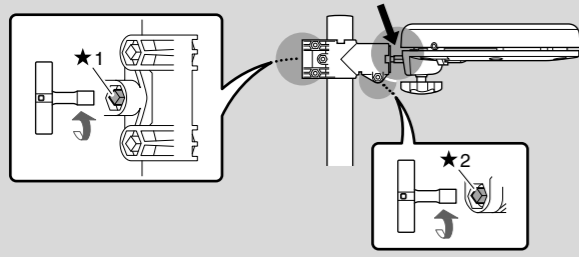

4. Adjust the angle of the snare pad by first loosening the key bolt (★1 and ★2 in the above figure). Tighten the key bolt securely after the adjustment.

- Step 5
- Step 6
- Step 7
- Step 8
- Step 9
- Step 10

Follow the instructions on pages 15 to 17 on the DTX402K, DTX432K, and DTX452K Owner's Manual. With **Step 5**, refer to the example for the DTX452K.

### Attaching an additional cymbal pad

Attaching an additional cymbal pad requires a stopper. By properly attaching the stopper prevents the cymbal pad from spinning during your performance and protects cables from damage.

1. Rotate the cymbal holder upward and tighten the clamp bolt, and then bring the cymbal tilter upward (fig. 1).

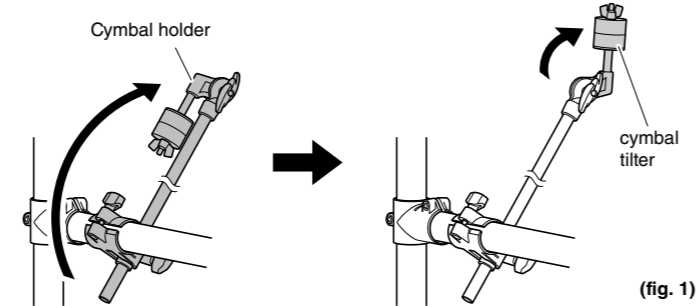

2. Loosen the key bolt on the stopper with a tuning key (fig. 2).
3. Remove the wing nut, two felt pads, and the bolt cover from the cymbal holder (fig. 3).
4. Slide the stopper onto the cymbal holder's shaft (fig. 4).

#### NOTE

If the key bolt was not sufficiently loosened in Step 2, it may not be possible to slide the stopper onto the cymbal holder's shaft. If this occurs, loosen the key bolt as much as possible without removing it.

5. Screw down the bolt cover to secure it into position (fig. 4).

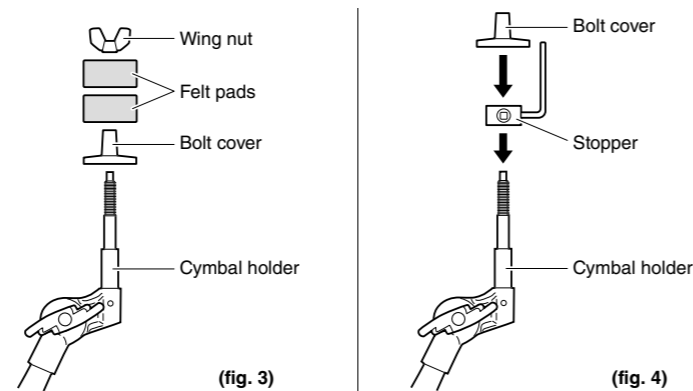
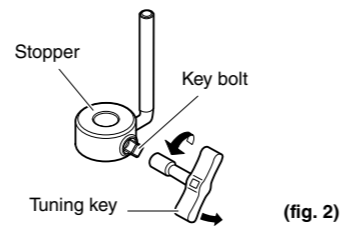

6. Place the stopper to make full contact with the bottom surface of the bolt cover and tighten the key bolt with a tuning key to secure the stopper (fig. 5).

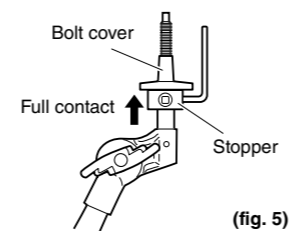
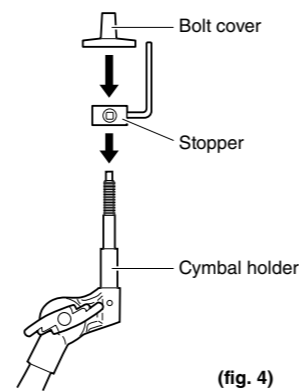

7. Place one of the felt pads removed at Step 3 to the cymbal holder (fig. 6).

8. Pass the end of the cymbal holder shaft through the large hole at the center of the cymbal pad, and the stopper pin through the small hole in the cymbal pad (fig. 6).

#### NOTE

If the stopper pin does not reach the small hole in the cymbal pad, the stopper will not hold the cymbal pad properly. Make sure to secure the stopper position as shown in Step 6.

9. Place the other felt pad on the cymbal holder (fig. 6).

10. Screw the wing nut to secure the pad to the cymbal holder (fig. 6).

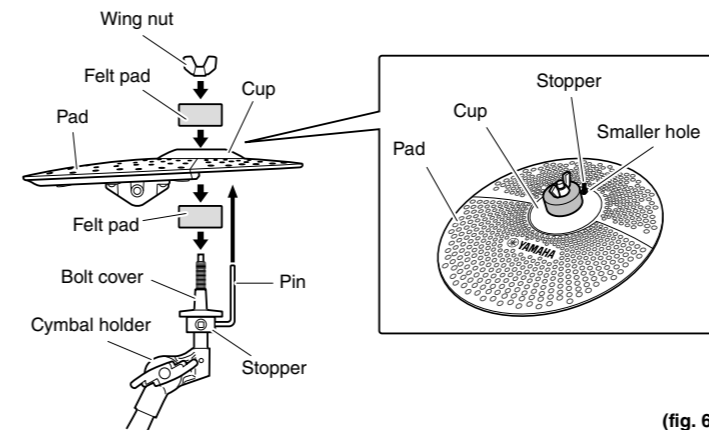

- Step 11
  - Step 12
  - Step 13
  - Step 14
- Follow the instructions on pages 18 to 20 on the DTX402K, DTX432K, and DTX452K Owner's Manual. For **Step 12** and **Step 14**, refer to the example for DTX452K. Using the cable bands, secure the cables to the kit rack at the ○ positions.

### Connecting an additional cymbal

1. Connect the L-shaped plug of the stereo phone cable into the [OUTPUT] jack of the cymbal pad.
2. Connect the other plug to the [PAD ▶ IN] jack on the KP65 kick pad.

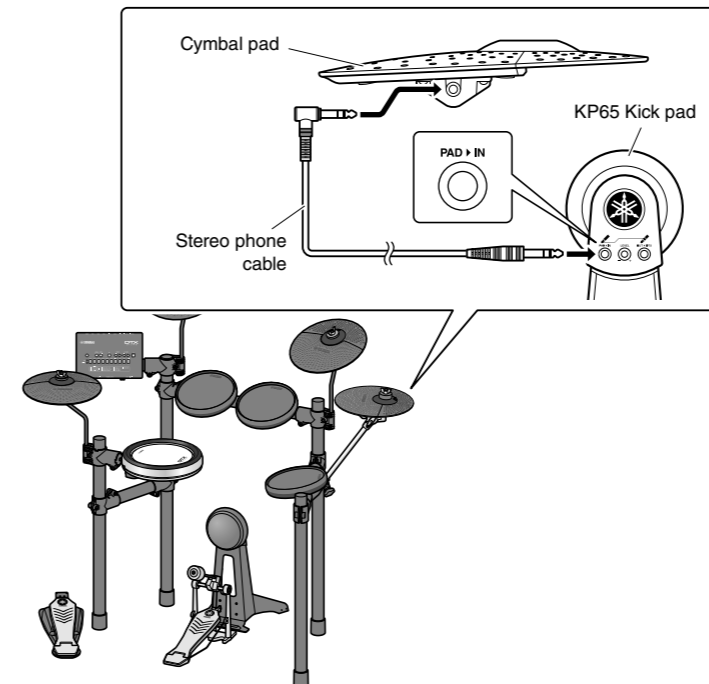

## 3. Setting up the drum module

Before you start using the drum module, power it up while simultaneously pressing number button [8]. Doing this optimizes the settings on your drum module for the DTX482K. Once the setup for the DTX482K is complete, there is no need to perform this procedure every time you turn on the drum module.

1. While holding down the number button [8], press [⏻] (Standby/On) button.

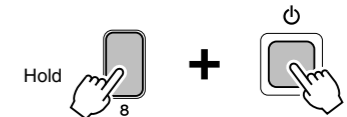

The number button [8] flashes while the settings on the drum module are updated.



This completes the setup.

#### NOTICE

Initializing the drum module erases the settings for the DTX482K. After initializing the drum module, make the initial settings for the DTX482K by carrying out the procedure shown above.